

Sawing receptacle

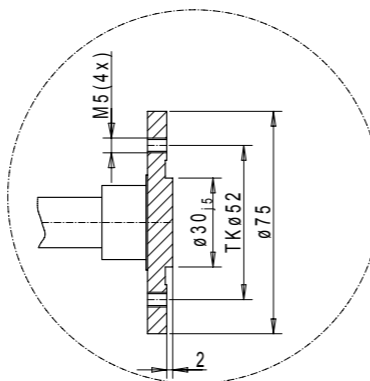
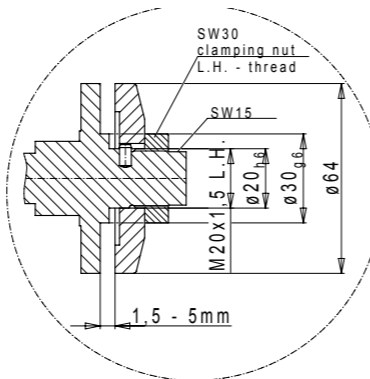
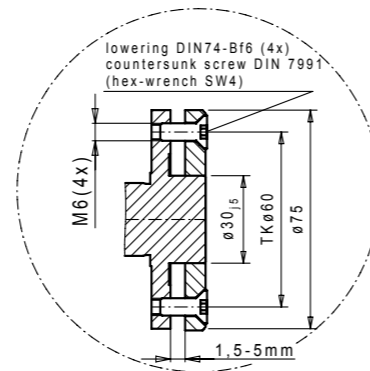

Technical features

Item Id.	EP-030046
drive turning direction	R.H./L.H.
drive speed max.	permanent operation 645 – 5.161 rpm
drive speed max.	interval operation 645 – 6.451 rpm
number of spindles	1
spindle position	horizontal
tool receptacle	Ø75/30 mm - 4xM6 – clamping area 1,5 - 5,0 mm
gear ratio	1 : 1,55 – wheel drive
turning direction of tool receptacle	opposite to drive turning direction
spindle speed max.	permanent operation 1.000 - 8.000 rpm
spindle speed max.	interval operation 1.000 - 10.000 rpm
drive capacity	3,0 kW
weight with drive adapter	approx. 4,50 kg

Optional accessories:

Hex-wrench SW4  
Lubrication press

Item Id. 138040  
Item Id. 980003

Attention:

With the angular sawing heads of the series W01 the use of saw blades is possible up to a maximum diameter of 300 mm. The freewheeling of the saw blade, however, has to be observed respectively the max. diameter has to be limited correspondingly - both depending on the used drive adapters and the drive cover contour (customer's part).

Variants on demand!

