

Technical features

| Item Id. | EP-031510 |
|--------------------------------------|---|
| drive turning direction | R.H./L.H. |
| drive speed max. | interval operation 7.742 rpm |
| number of spindles | 1 |
| spindle position | horizontal |
| tool receptacle | 1x milling receptacle $\varnothing 16h6 \times 10$ mm |
| gear ratio | 1 : 1,55 – wheel- and tooth belt drive |
| turning direction of tool receptacle | 1x opposite to drive turning direction |
| spindel speed max. | interval operation 12.000 rpm |
| drive capacity | 2,5 kW at 12.000 rpm |
| weight with drive adapter | approx. 4,00 kg |

Optional accessories:

Hex-wrench SW6
Lubrication press

Item Id. 138060
Item Id. 980003

The angular heads of the G15 series are used as edge notching aggregates. The drive speed is transmitted in the ratio 1:1,55 to the tool receptacles. A maximum spindle speed up to 12.000 rpm is possible in interval operation.

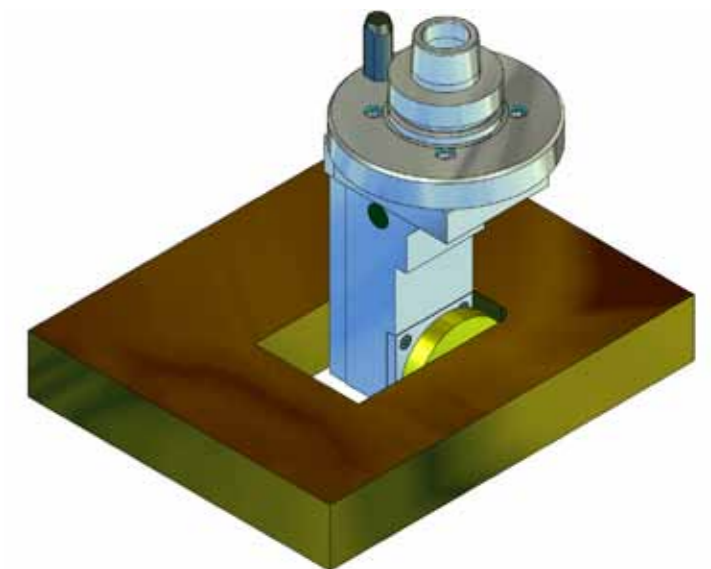
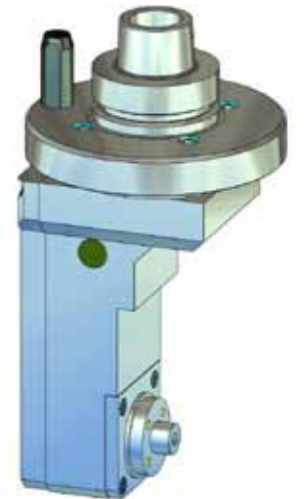

Variants on demand!